

This **GENERAL VESTING DECLARATION** is made on the 18th April 2012 by Reading Borough Council ("the Authority").

WHEREAS:

- (1) On 9 February 2012 an order entitled the Reading Borough Council (Land at Helmsdale Close, Tilehurst, Reading) Compulsory Purchase Order 2012 was confirmed by the Authority under the powers conferred on it by the Town and Country Planning Act 1990 and Acquisition of Land Act 1981 authorising the Authority to acquire the land specified in the Schedule hereto.
- (2) Notice of confirmation of the order was first published in accordance with section 15 of the Acquisition of Land Act 1981 on 16 February 2012.
- (3) That Notice included the particulars specified in section 3(3) of the Compulsory Purchase (Vesting Declarations) Act 1981 ("the Act").
- (4) The Notice referred to in (3) above did not specify any period longer than two months beginning with the date of its first publication as the period before the end of which this General Vesting Declaration could not be executed.

NOW THIS DEED WITNESSETH that, in exercising the powers conferred on it by section 4 of the Act, the Authority hereby declare:

1. The land described in the Schedule hereto being the whole of the land authorised to be acquired by the order and more particularly delineated on the plan annexed hereto, together with the right to enter upon and take possession of the land shall vest in the Authority as from the end of the period of **28** days from the date on which service of notices required by section 6 of the Act is completed.

SCHEDULE

Number on map (1)	Extent, description and situation of land (2)	Qualifying persons under section 12(2)(a) of the Acquisition of Land Act 1981 – name and address (3)			
		Owners or reputed owners	Lessees or reputed lessees	Tenants or reputed tenants (other than lessees)	Occupiers
1	All interests in 25 square metres or thereabouts of land and garages on Helmsdale Close, Tilehurst, Reading RG30 2PT otherwise known as Garages 20 and 21 Helmsdale Close (except those owned by the Authority)	<p>1. Reading Borough Council Civic Offices Civic Centre Reading RG1 7AE</p> <p>Whole of freehold title number BK448564 being Garages 20 and 21 Helmsdale Close</p>	-	-	1. Owner
2	All interests in 12 square metres or thereabouts of land and garage on Helmsdale Close, Tilehurst, Reading otherwise known as Garage 54 Helmsdale Close	<p>1. Nneka Obediah Obutor 59 Helmsdale Close Reading RG30 2PT</p> <p>Part of freehold title number BK235539 being Garage 54, Helmsdale Close</p>	-	-	1. Owner

Date: 18 APRIL 2012

THE COMMON SEAL of READING BOROUGH)
COUNCIL was hereunto affixed)
in the presence of :-)

Authorised Officer

MINUTE	Cabinet 31.10.11 min 76
ORIGINATOR	Bond Pearce
SEAL NO	124/12
CHECKED	

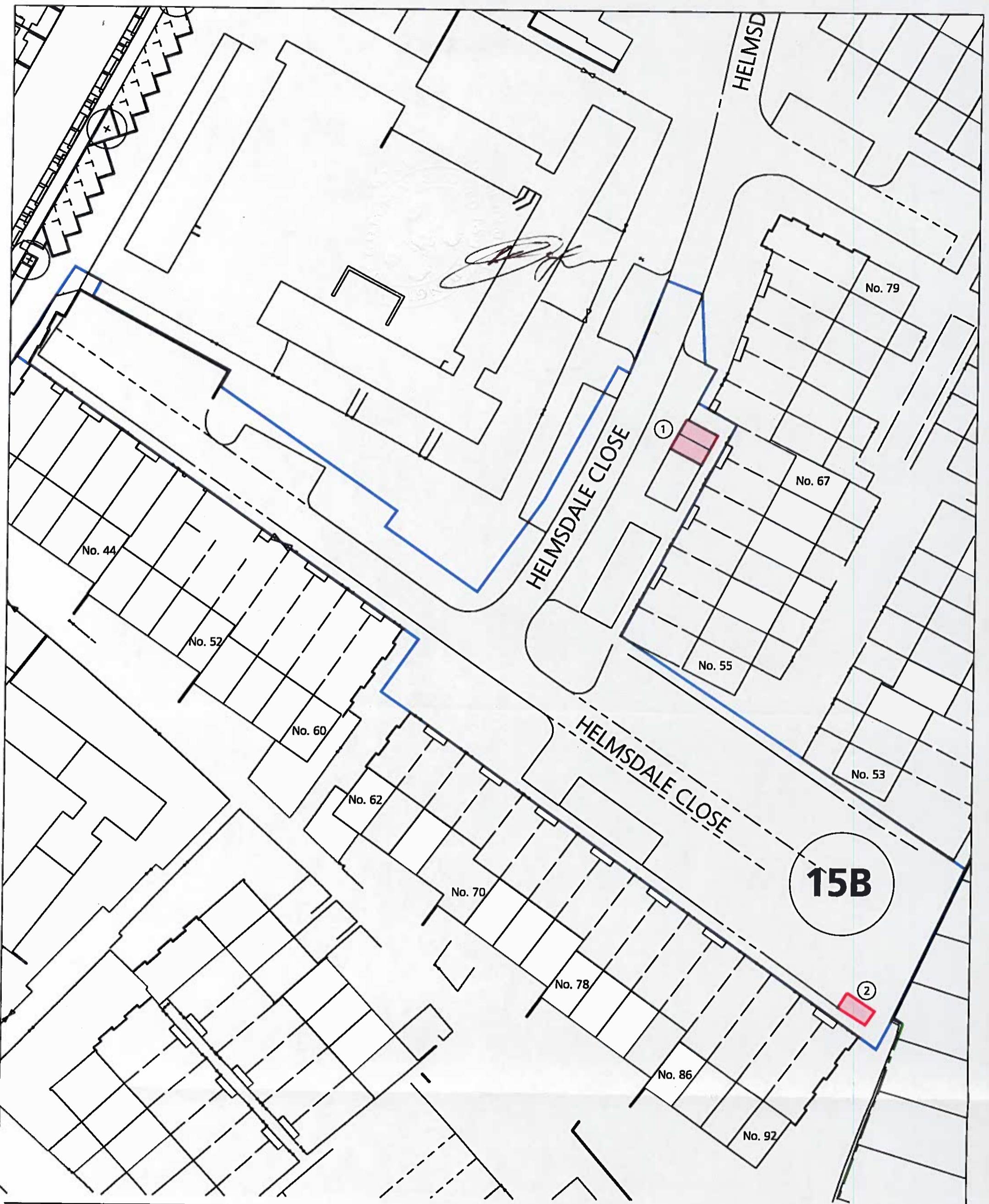

The Reading Borough Council
 (Land at Helmsdale Close, Tilehurst, Reading)
 Compulsory Purchase Order 2012

GENERAL VESTING DECLARATION PLAN

Scale 1:500 @A3
 Drawing no. 404

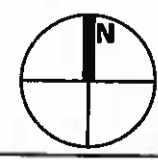

- Key:
- Land in 3rd party ownership
 - Site boundary of Phase 2A Sites
 - Overall Dee Park Regeneration Boundary